

AERIAL PHOTO
NTS

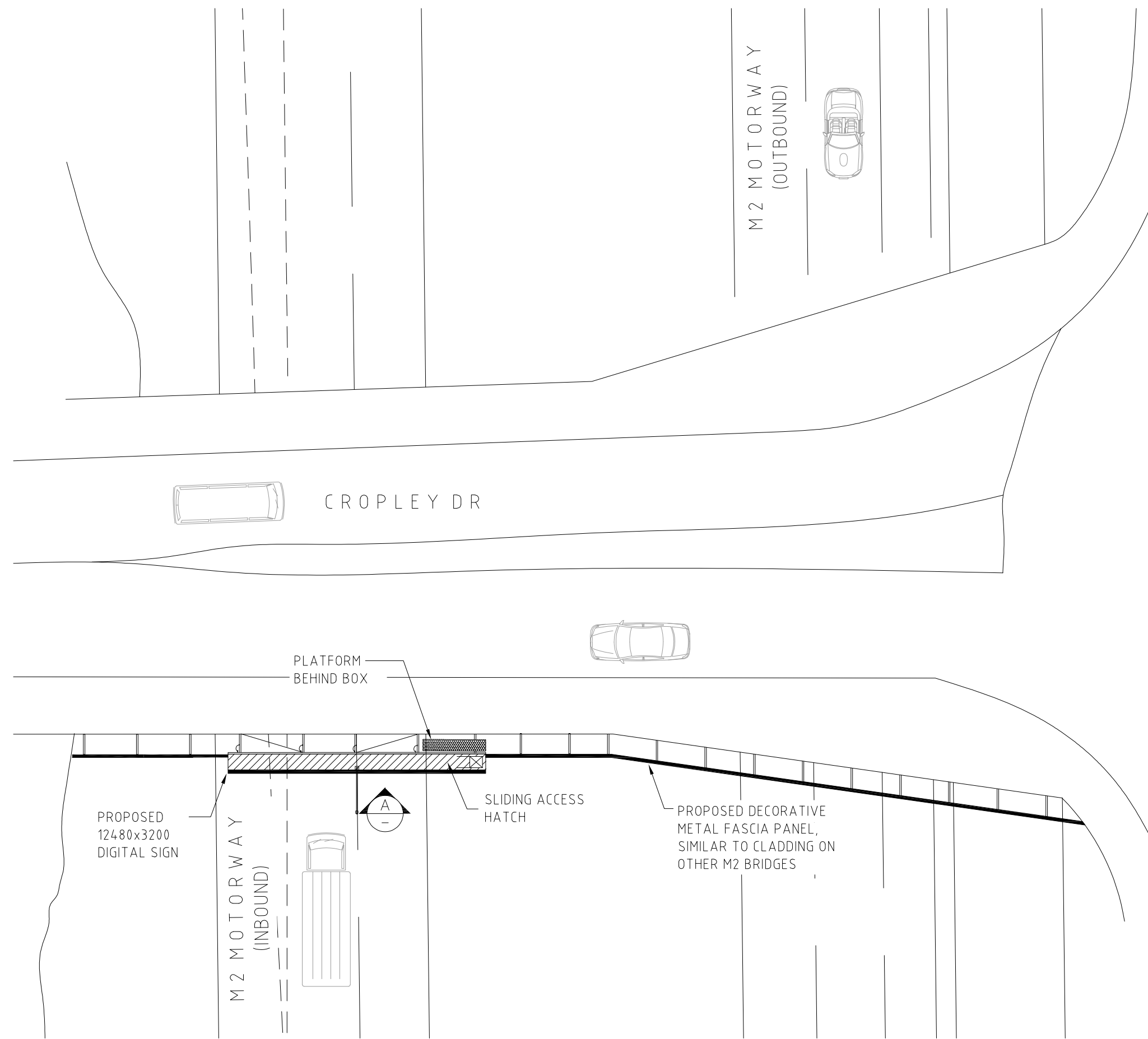

PROPOSED SITE PLAN
SCALE 1:200

RL'S ARE APPROXIMATE

FALL RESTRAINT CABLE TO BE FIXED BETWEEN SIGNBOX AND BRIDGE

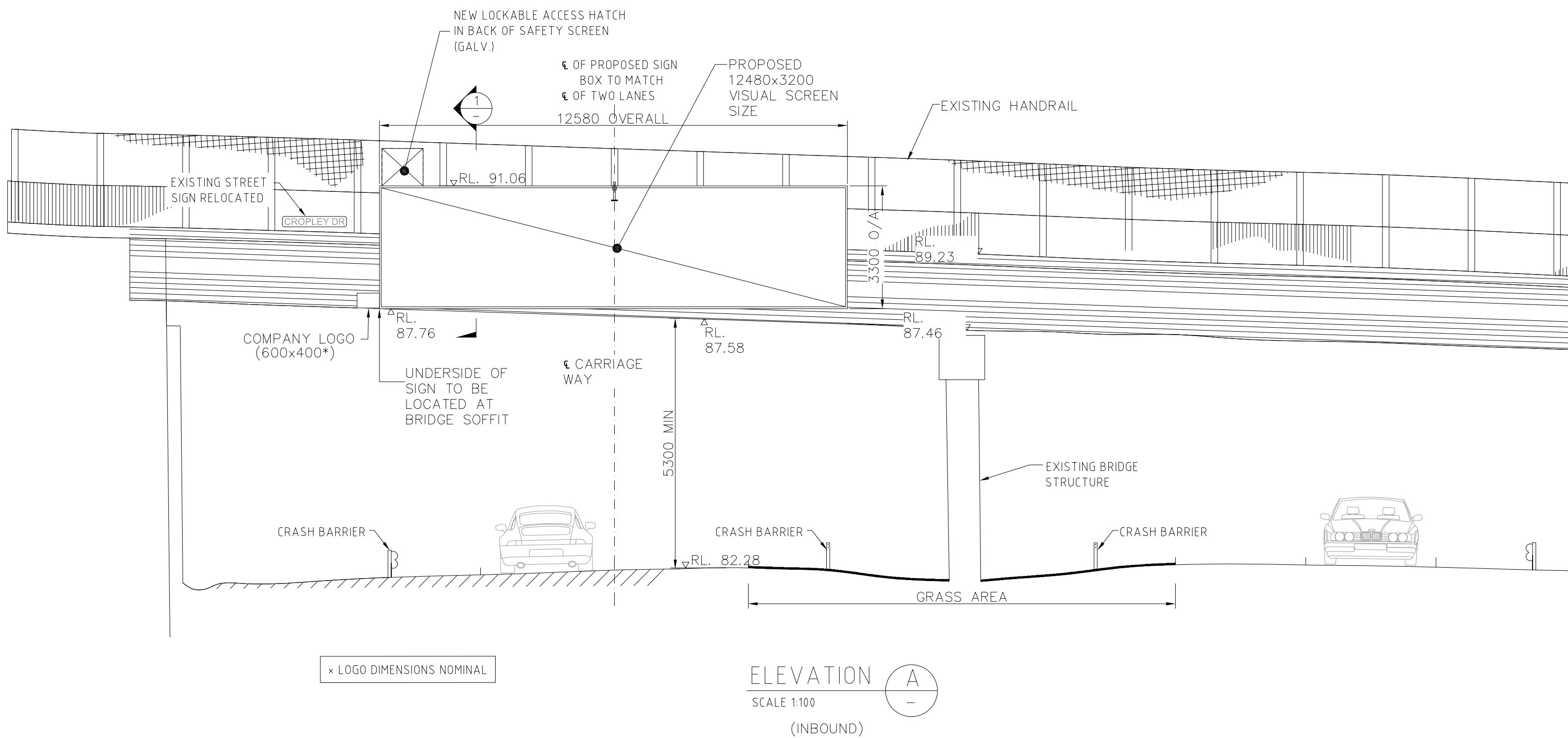

x LOGO DIMENSIONS NOMINAL

ELEVATION A
SCALE 1:100
(INBOUND)

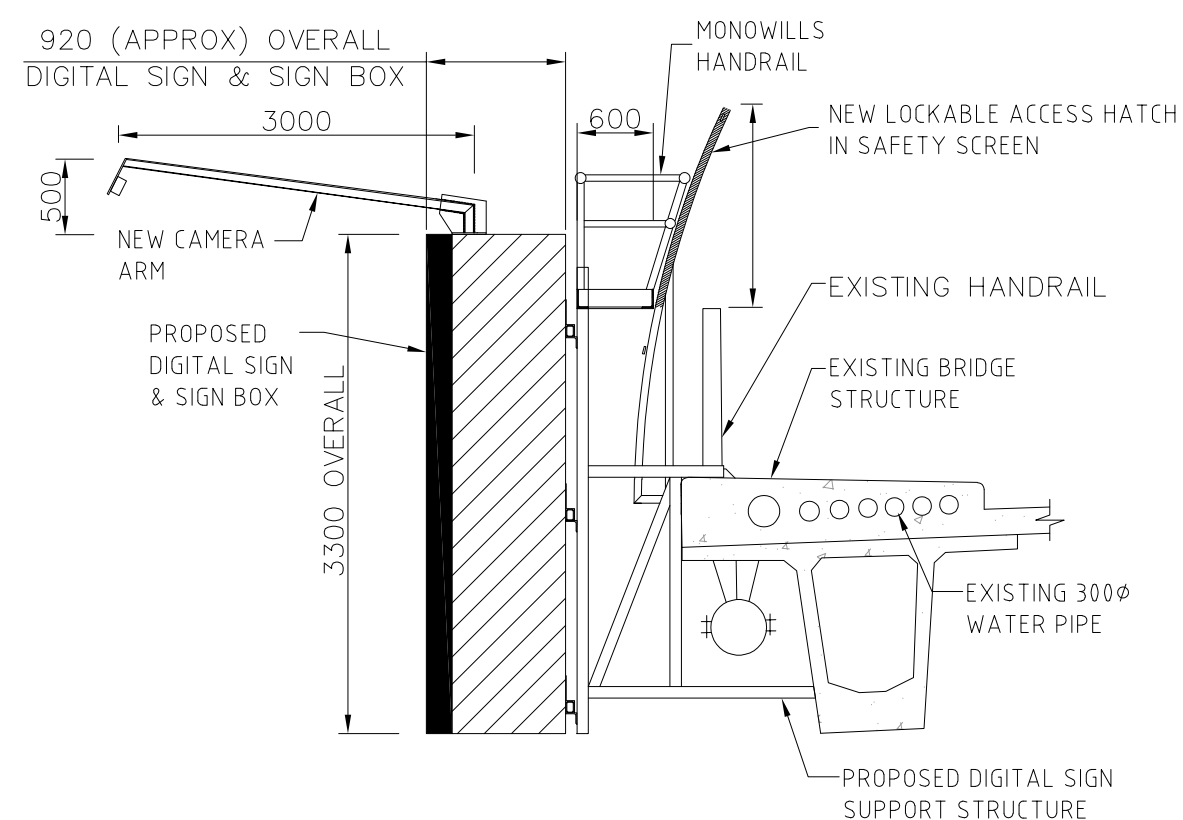

SECTION 1
SCALE 1:50

NOT FOR CONSTRUCTION

ISS	DATE	COMMENT
A	24/08/22	ISSUED FOR APPROVAL
B	06/10/22	ISSUED FOR APPROVAL
C	17/03/23	ISSUED FOR APPROVAL



Suite 4, Building 7, 49 Frenchs Forest Road East,
Frenchs Forest, NSW 2086
P.O. Box 652, Forestville, NSW 2087
Ph: 02 9451 3455 Fax: 02 9451 3466
Email: info@dbce.com.au
ABN 23 039 013 724

CLIENT:
MANBOOM

PROJECT:
CROPLEY DRIVE OVERPASS,
BAULKHAM HILLS, INBOUND & OUTBOUND

TITLE:
**PROPOSED DIGITAL SIGNS
GENERAL ARRANGEMENT &
SITE PLAN, ELEVATION &
SECTION**

DRAWN	DESIGN	DATE:
MT	JL	Aug22
JOB NO:	22141-6	DWG NO: DA01
SCALE @ A1:AS SHOWN	REV: C	